

Q Search UniFi products

- UniFi Cloud Gateways
- Switching
- WiFi
- Camera Security
- Door Access
- CloudKeys & Gateways
- Power Tech
- Integrations
- Accessories

Hubs > [Access Ultra](#)

Datasheet

- In The Box**
- Marketing Images
- Installation Guide

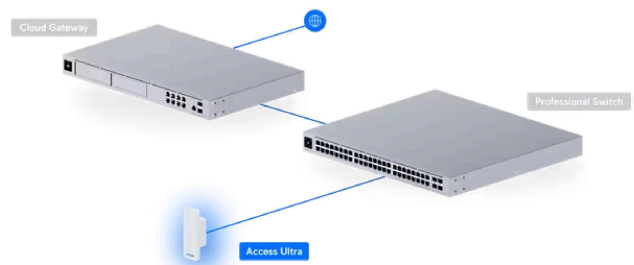
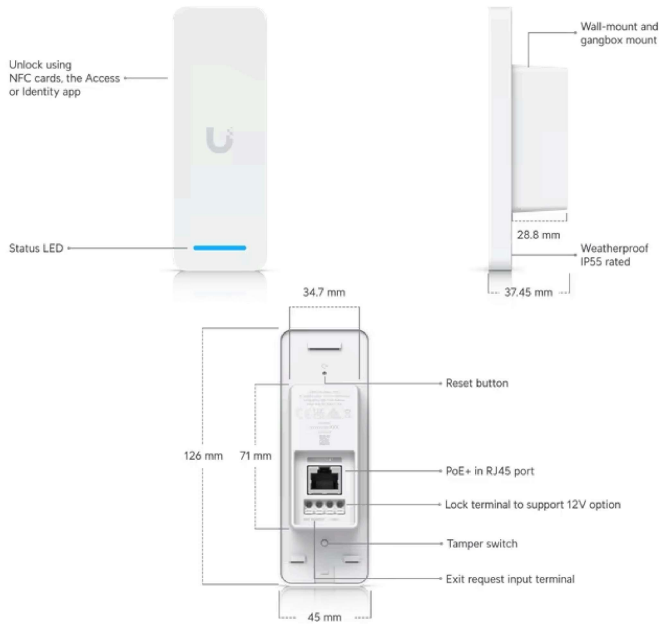

^ **Overview**

Dimensions 126 x 45 x 37.45 mm (4.9 x 1.8 x 4.5")

NFC Card & Keyfob Access ✓

Mobile Unlock ✓

Handwave Request to Exit ✓

Tamper Switch ✓

Weatherproofing IP55

UniFi Application Suite Access

^ **Mechanical**

Weight 140 g (4.9 oz)

Enclosure Material Polycarbonate, aluminum alloy

Mount Material Stainless steel

Mounting Wall mount, gang box mount (Included)
Junction box (Optional)

^ **Hardware**

Indoor and Outdoor Use Yes

Ambient Operating Temperature -30 to 40° C (-22 to 104° F)

Ambient Operating Humidity 5 to 90% noncondensing

Networking Interface	(1) 10/100 MbE RJ45 port
Connectivity	BLE 4.2 Ethernet
Power Method	PoE+ UL 294 Power-limited Class 2 PSU UL 60950-1/62368-1 LPS/PS2 PSU
Max. Power Consumption	18W
Supported Voltage Range	44—57V DC
ESD/EMP Protection	Air: ±8kV, contact: ± 4kV
Speaker	✓
LEDs	R/G/B/W Learn More
Button	(1) Factory-reset
NFC Frequency	13.56 Mhz
NFC Read Range	< 50 mm (1.95")
NFC Technology	ISO 14443A, 14443B, 15693 NFC Tag 1,2,3,4,5 MIFARE Classic MIFARE Plus Mifare Ultralight MIFARE DESFire
PoE Cabling Requirements	Cat 5e cabling is the minimum performance category recommended. The performance category utilized should match the transmission speed required at the installation site. The minimal conductor gauge permitted to connect between the PSE or power injector and the PD shall be 26 AWG (0.13 mm ²) for patch cords; 24 AWG (0.21 mm ²) for horizontal or riser cable.
UL 294 Level	Destructive attack: Level I Line security: Level I Endurance: Level I Standby power: Level I
UL 294 Statement	Compliance with IEEE 802.3 specifications was not verified as part of UL 294. The equipment is intended to comply with the section of the National Electrical Code, ANSI/NFPA 70, Article 725.121, Power Sources for Class 2 and Class 3 Circuits.
CAN/ULC-60839-11-1 Grade	Grade assignment: I
Certifications	CE, FCC, IC, UL 294, CAN/ULC-60839-11-1
Document number, and issue date and/or revision level	UA-Ultra, V01
^ Software	
Management Application	Access
Software Information	The software version can be checked at https://unifi.ui.com

Stay in Touch



[Terms of Service](#) | [Privacy Policy](#) | [Legal](#) | [Cookies Settings](#)

© 2025 Ubiquiti, Inc. All rights reserved.